

Section B

FINISHING PANELS

IMPORTANT

All the panel prices quoted in the following chapters are inclusive of **Brown Ral colour 8017 inside / outside panel-fixing frames.**

If inside / outside panel-fixing frames are required in different colours, the below-mentioned **extra cost** must be added to the panel price.

EXTRA COST FOR INSIDE/OUTSIDE PANEL-FIXING FRAMES DIFFERENT FROM STANDARD COLOUR BROWN RAL 8017

RAL COLOUR	SINGLE LEAF	DOUBLE LEAF
RAL AS PER SAMPLE	52,21	105,04
WHITE RAL 9010	31,20	63,03
SILVER GREY RAL 9006	31,20	63,03
BLACK RAL 9005	31,20	63,03
WALNUT COLOUR	31,20	63,03

FINISHING PANELS

Chap. 11 - DIBIDOKU COLLECTION

NOTE: If inside/outside panel-fixing frames are required in colours different from the standard Brown Ral 8017, the extra cost quoted on page B-2 of this price list must be added to the panel price.

NOTE: In case of double leaf panels with symmetric leaves, the total amount of the finishing panel has to be calculated doubling the price of the single leaf.

DIBIDOKU COLLECTION (8 mm thick)

Coloured HDF

(Application is permitted only inside, in positions protected from atmospheric agents)

Available colours:

MDF Anthracite	MDF Grey
MDF Blue	MDF Orange
MDF Brown	MDF Red
MDF Green	MDF Yellow



The door panels are available in the dimension 900 X 2100. (1)

PRICE OF EACH MODULE (2)

	1	2	3	4	5	6	7	8	9		PRICE	
1											<u>Module A</u>	<u>5,20</u>
2											<u>Mobule B</u>	<u>8,32</u>
3											<u>Module C</u>	<u>11,44</u>
4											<u>Module D</u>	<u>15,60</u>
5											<u>Module E</u>	<u>20,80</u>
6											<u>Module F</u>	<u>27,04</u>
7											<u>Module G</u>	<u>8,32</u>
8											<u>Module H</u>	<u>11,44</u>
9											<u>Module I</u>	<u>20,80</u>
10												
11												
12												
13												
14												
15												
16												
17												
18												
19												
20												
21												

PRICE OF MODULES AVAILABLE WITH NUMBERS AND TYPES

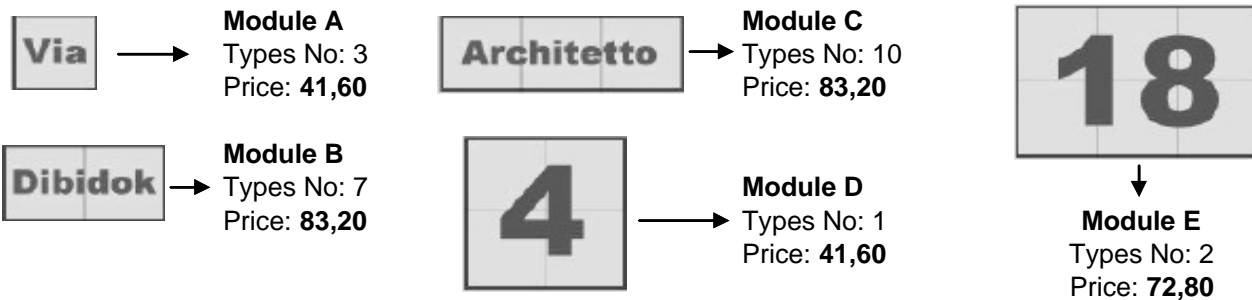

(1) The availability of the panel with different dimensions is subject to a feasibility study and estimate. Contact our Order Department.

(2) For the inside door panels, add euro 26.42 for the inside panel-fixing frames.

DIBIDOKU COLLECTION (8 mm thick)

Coloured HDF

(Application is permitted only inside, in positions protected from atmospheric agents)



ALREADY PREPARED MODELS

MOD. 001

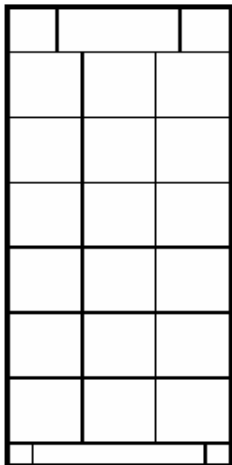

PANEL COMPOSITION:	
18 Modules F	
2 Modules A	
2 Modules B	
2 Modules G	
2 Modules D	
1 Module E	
1 Module C	

PRICE*	
593,84	

MOD. 002

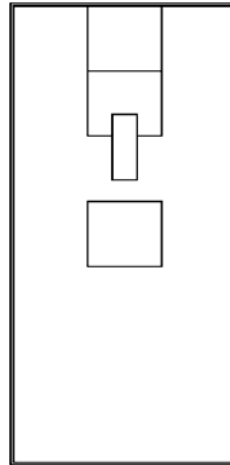

PANEL COMPOSITION:	
19 Modules F	
5 Modules H	
1 Modules G	
1 Module A	

PRICE*	
584,48	

MOD. 003

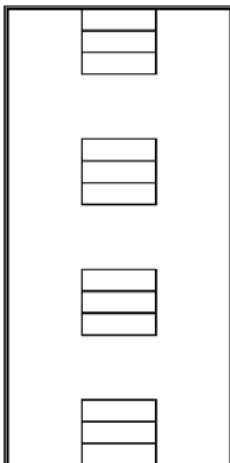

PANEL COMPOSITION:	
17 Modules F	
12 Modules C	

PRICE*	
596,96	

MOD. 004

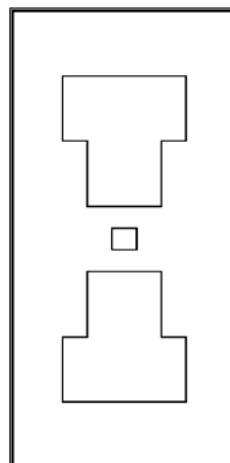

PANEL COMPOSITION:	
14 Modules F	
4 Modules I	
9 Modules A	
8 Modules H	
2 Modules C	

PRICE*	
622,96	

MOD. 005

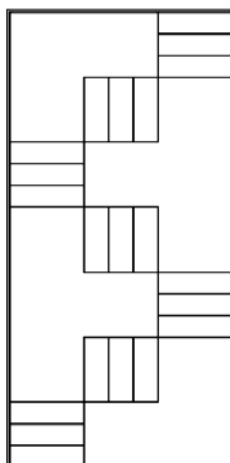

PANEL COMPOSITION:	
15 Modules F	
12 Modules C	
6 Modules H	

PRICE*	
611,52	

MOD. 006

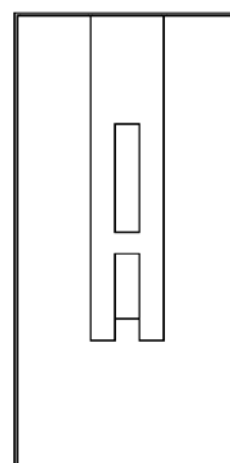

PANEL COMPOSITION:	
17 Modules F	
10 Modules H	
4 Modules A	
1 Module G	

PRICE*	
603,20	

* In the quoted prices, the cost of design and installation of types and/or numbers in the modules is not included.
NOTE: For the inside door panels, add euro 26,42 for the inside panel-fixing frames.

DIBIDOKU COLLECTION (8 mm thick)

Coloured HDF

(Application is permitted only inside, in positions protected from atmospheric agents)



MOD. 007

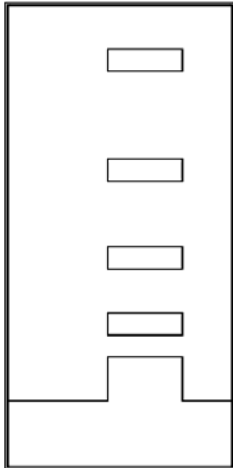

PANEL COMPOSITION:	
10 Modules F	
5 Modules E	
5 Modules I	
7 Modules C	
5 Modules H	
1 Module A	
1 Module B	

PRICE*	
629,20	

MOD. 008

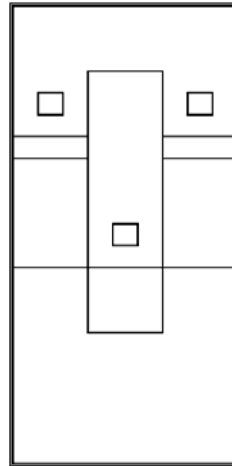

PANEL COMPOSITION:	
16 Modules F	
8 Modules C	
9 Modules A	
2 Modules E	

PRICE*	
612,56	

MOD. 009

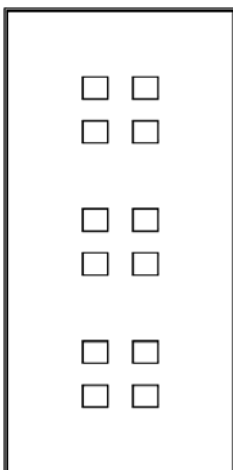

PANEL COMPOSITION:	
18 Modules F	
18 Modules A	
3 Modules H	

PRICE*	
614,64	

MOD. 010

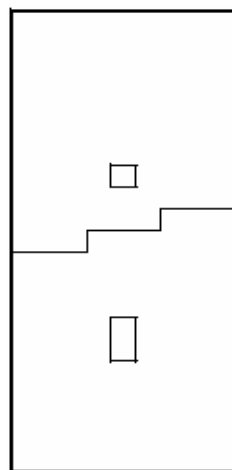

PANEL COMPOSITION:	
16 Modules F	
4 Modules C	
7 Modules A	
4 Modules E	
1 Module G	

PRICE*	
606,32	

MOD. 011

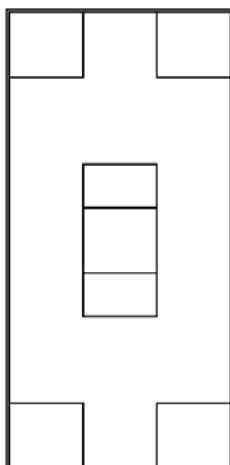

PANEL COMPOSITION:	
19 Modules F	
2 Modules E	
2 Modules C	

PRICE*	
578,24	

MOD. 012

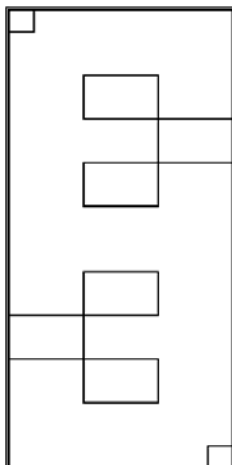

PANEL COMPOSITION:	
11 Modules F	
14 Modules E	
2 Modules A	
2 Modules B	

PRICE*	
615,68	

* In the quoted prices, the cost of design and installation of types and/or numbers in the modules is not included.
NOTE: For the inside door panels, add euro 26,42 for the inside panel-fixing frames.

DIBIDOKU COLLECTION (8 mm thick)

Coloured HDF

(Application is permitted only inside, in positions protected from atmospheric agents)



MOD. 013

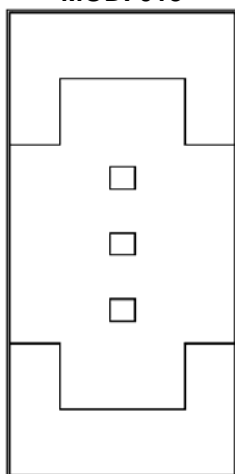

PANEL COMPOSITION:
14 Modules F
10 Modules H
4 Modules I
9 Modules A

PRICE*
622,96

MOD. 014

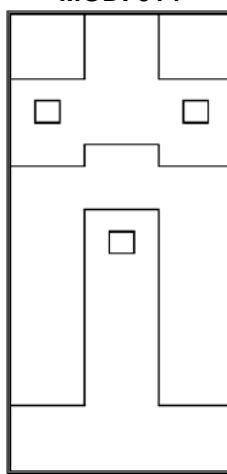

PANEL COMPOSITION:
15 Modules F
3 Modules E
9 Modules A
6 Modules H
3 Modules C

PRICE*
617,76

MOD. 015

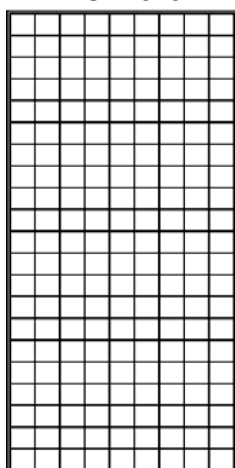

PANEL COMPOSITION:
189 Modules A

PRICE*
982,80

MOD. 016

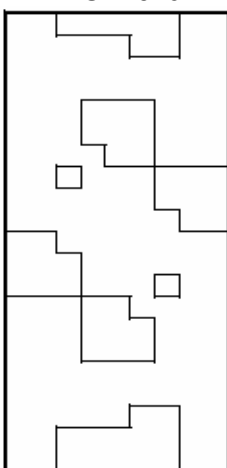

PANEL COMPOSITION:
5 Modules F
9 Modules E
6 Modules I
3 Modules D
5 Modules C
1 Module H
8 Modules B
1 Module G
6 Modules A

PRICE*
668,72

MOD. 017

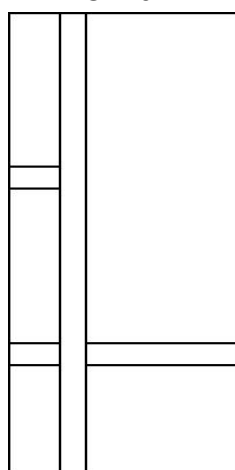

PANEL COMPOSITION:
3 Modules B
3 Modules C
1 Module D
2 Modules E
12 Modules F
1 Module G
6 Modules H
5 Modules I
PRICE*
621,92

MOD. 018

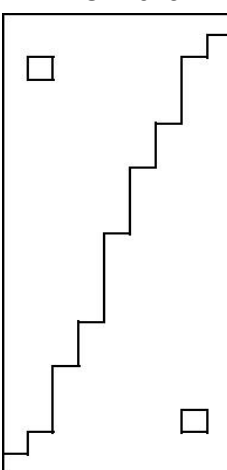

PANEL COMPOSITION:
11 Modules A
4 Modules D
8 Modules E
6 Modules F
10 Modules I
PRICE*
656,24

* In the quoted prices, the cost of design and installation of types and/or numbers in the modules is not included.
NOTE: For the inside door panels, add euro 26,42 for the inside panel-fixing frames.

DIBIDOKU COLLECTION (8 mm thick)



Coloured HDF

(Application is permitted only inside, in positions protected from atmospheric agents)

MOD. 019

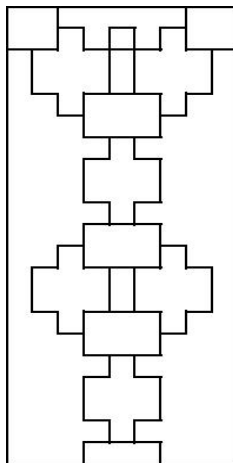

PANEL COMPOSITION:	
24 Modules A	
8 Modules B	
1 Module C	
2 Modules D	
9 Modules E	
8 Modules F	
6 Modules G	
PRICE*	
687,44	

MOD. 020

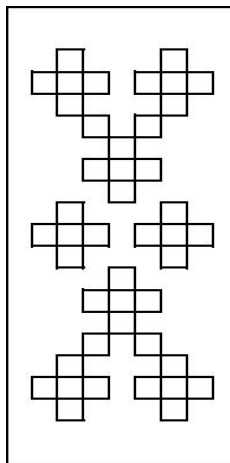

PANEL COMPOSITION:	
63 Modules A	
12 Modules B	
4 Modules C	
12 Modules E	
2 Modules F	
PRICE*	
776,88	

* In the quoted prices, the cost of design and installation of types and/or numbers in the modules is not included.
NOTE: For the inside door panels, add euro 26,42 for the inside panel-fixing frames.